

MODE

In order to switch between modes, simultaneously press and hold the two buttons highlighted below for one second. The wheel base LED indicates the active mode:

- Red indicates PC mode
- Blue indicates PS4™ mode*
- Purple indicates compatibility mode*

* Not applicable for every Fanatec wheel base. Please check the individual user manual of your Fanatec wheel base.

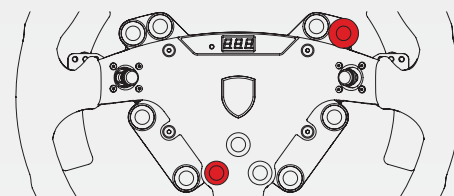

BUTTON MAPPING

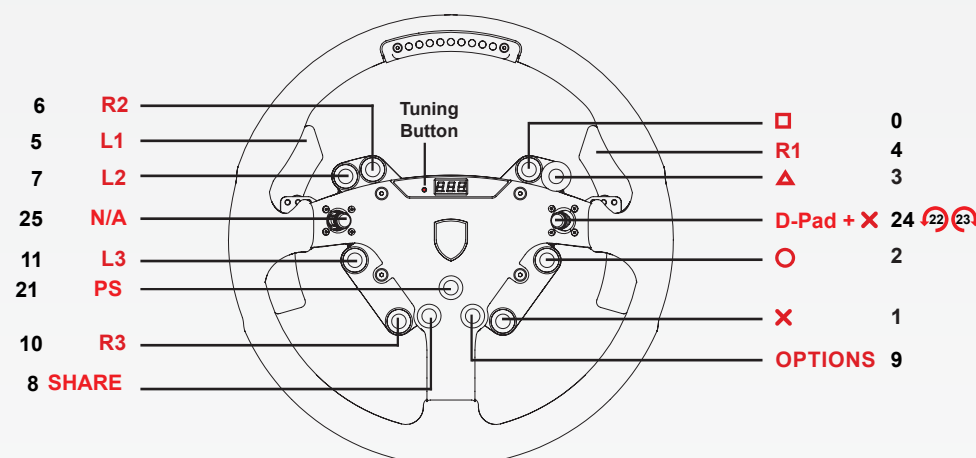

CENTRE CALIBRATION

If a centre calibration is needed (e.g: after firmware update of ClubSport Wheel Base) when using the steering wheel you need to enter the Tuning Menu by pressing the Tuning Button.

When the Tuning Menu is active, press the analogue stick and the FunkySwitch™ at the same time as illustrated on the right in order to calibrate the wheel centre.

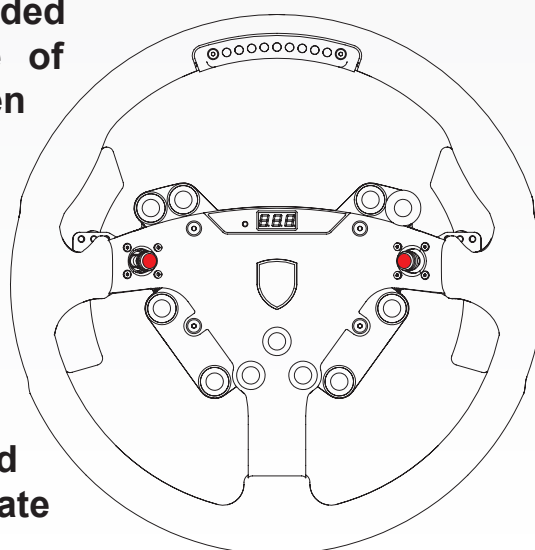

TUNING OPTIONS

In order to enter Tuning Menu, press the Tuning button. In order to navigate inside the menu, use the right FunkySwitch™. Press it up or down to access 5 setups. Press the FunkySwitch™, right or left, to go through the options and turn the FunkySwitch™ to change option values.

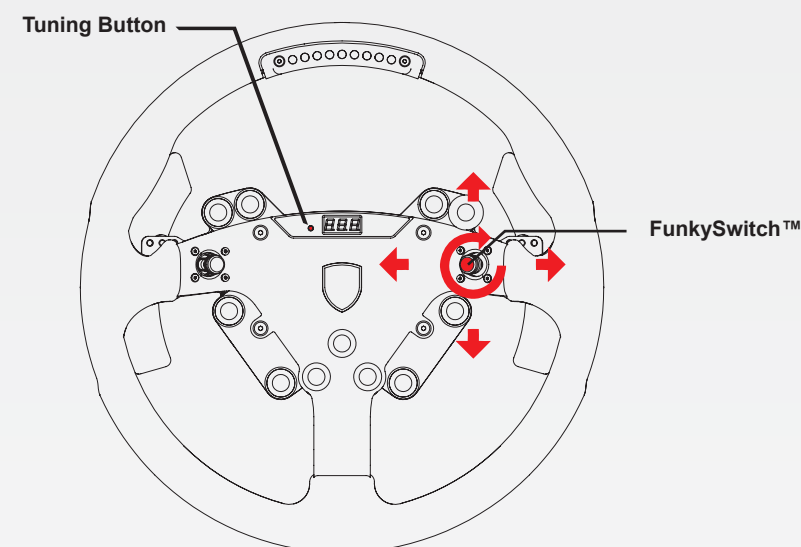

SHIFTER CALIBRATION

In order to enter shifter calibration mode, simultaneously press the Tuning Button and the button highlighted below.

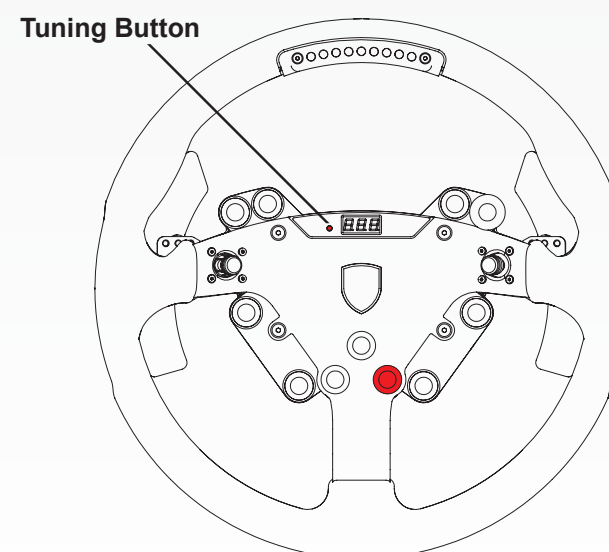

FANATEC®

ClubSport
Porsche 918 RSR



Quick Guide

EN



www.fanatec.com

ATTACHING THE STEERING WHEEL



Make sure the newest CSW Base firmware file has been downloaded. You can obtain it at Fanatec's website (www.fanatec.com) in the download section.

- Remove storage pin

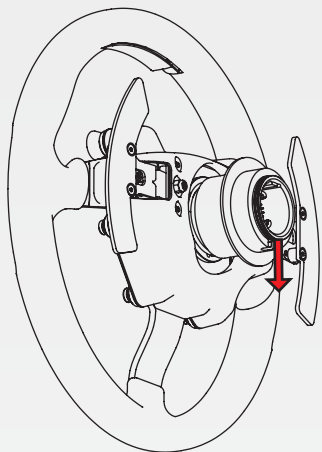

- Align ClubSport Wheel Base axle, to correct position

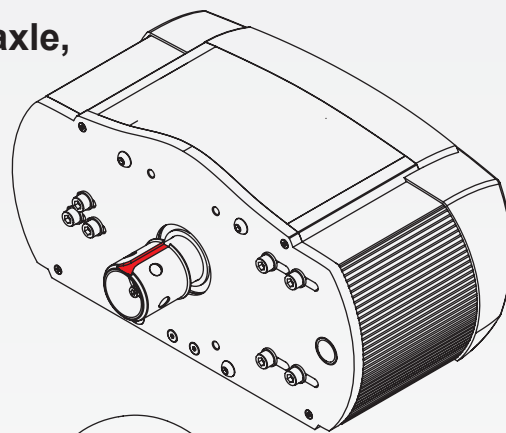

- Press together or "pinch" and hold Quick Release mechanism

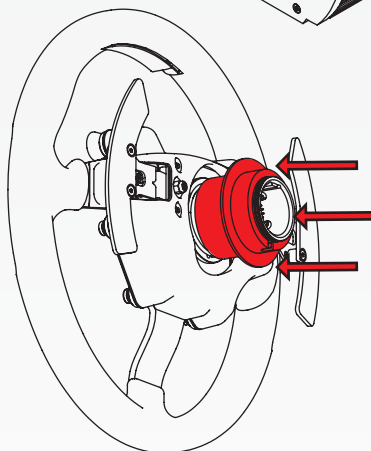

- Slide Rim onto ClubSport Wheel Base axle

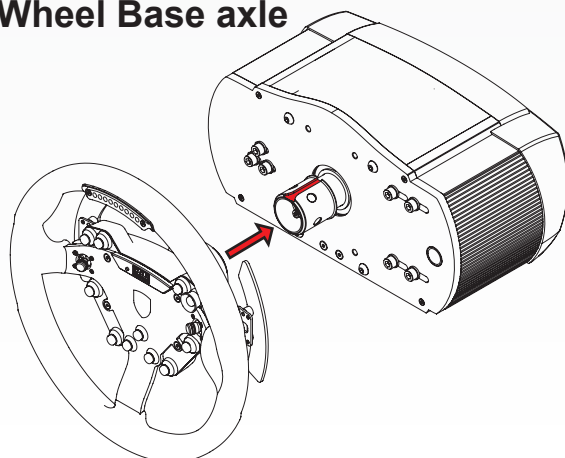

- Now release the sleeve of the Quick Release mechanism

DETACHING THE STEERING WHEEL

- Pinch and hold Quick Release mechanism

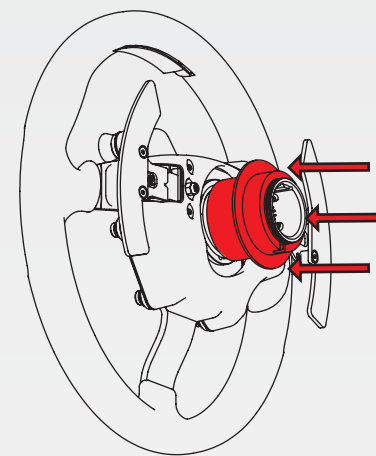

- Slide Rim off ClubSport Wheel Base axle

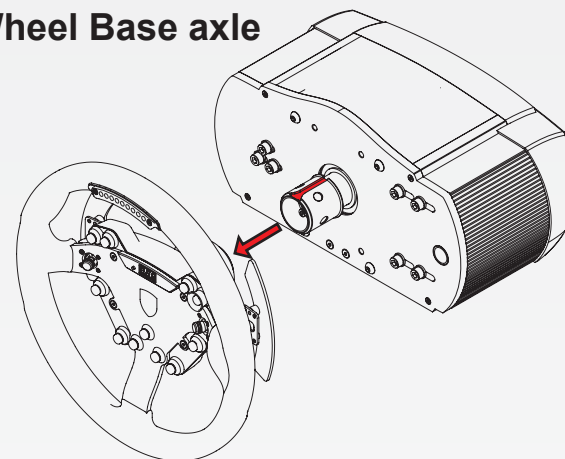

- Place Rim face down on table

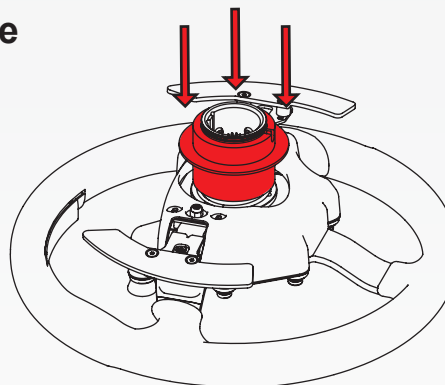

- Insert storage pin

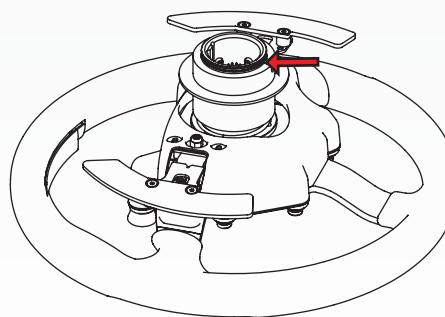

- Now release the sleeve of the Quick Release mechanism

SHIFTER PADDLE OPTIONS

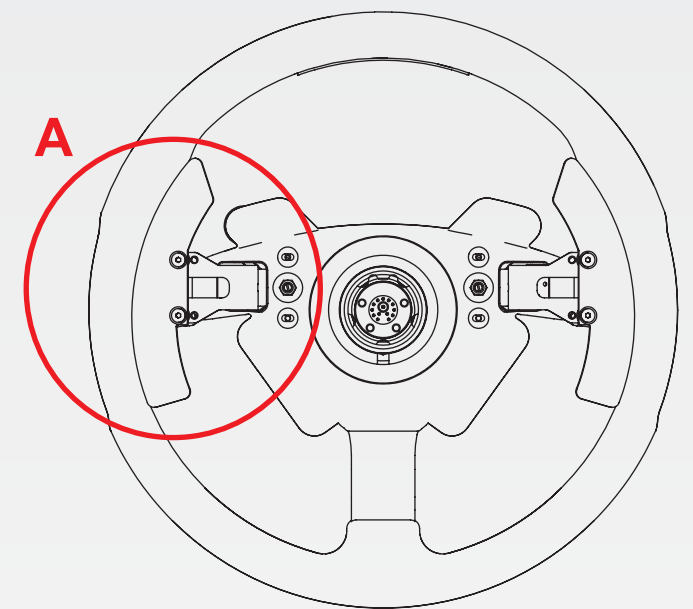

Detail A

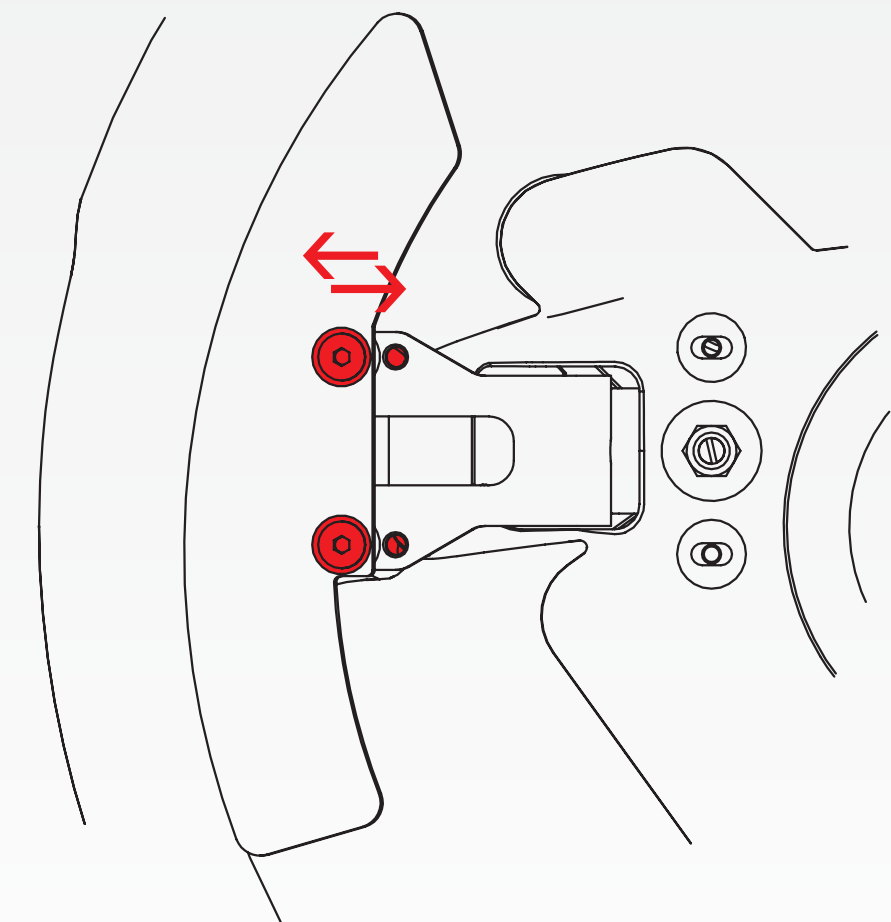

Manufactured by

ENDOR

Fanatec is a registered trademark of Endor AG
Designed and developed by Endor AG in Germany
E.ON-Allee 3 - 84036 Landshut - Germany
Telephone: +49 (871) 9221-122 Fax: +49 (871) 9221-221
Email: info.webshop@fanatec.com
Website: www.fanatec.com - www.endor.ag